

**OFFICER DELEGATION SCHEME
RECORD OF OPERATIONAL DECISION**



TO BE UPLOADED TO THE E-MEETINGS MANAGER

Date: 19.02.19	Ref No: 3247
Type of Operational Decision:	
Executive Decision <input checked="" type="checkbox"/>	Council Decision <input type="checkbox"/>
Status: For publication	
Title/Subject matter: Denton Street, Bury – Temporary Closure	
Budget/Strategy/Policy/Compliance – Is the decision:	
(i) within an Approved Budget	√
(ii) not in conflict with Council Policy	√
(iii) not raising new issues of Policy	√
Equality Analysis [Does this decision change or make policy; change or make procedure or working practice? An Equality Analysis must be completed to assess the impact on equality and the relevance of the Public Sector Equality Duty. This should be signed off by your departmental equality representative and accompany this decision form. Please forward a copy to the Equality email for publication].	No
	Signed: (By EA Officer)
	Date:
Details of Operational Decision Taken [with reasons]:	
Approval to the temporary closure under Section 14(1) of the Road Traffic Regulation Act 1984, of Denton Street, Bury (between Back Hornby Street East and Back Walmersley Road West) from Sunday 12 May 2019 for a period of 1 month to facilitate manhole cover and frame replacement works (anticipated duration 1 day, 08.30-15.30). The diversion route is via Walmersley Road, Eldon Street and Hornby Street and vice-versa.	
Decision taken by:	Signature:
D R Giblin Head of Engineering	
	Date:
	19/02/19
Members Consulted [see note 1 below]	
Cabinet Member/Chair	

Lead Member		
Opposition Spokesperson		

Notes

1. It is not generally a requirement to consult with any Members on Operational Decisions but where an Executive Director considers it necessary to consult with the appropriate Cabinet Member and/or Lead Member, they must sign the form so as to confirm that they have been consulted and that they agree with the proposed action. The signature of the Opposition Spokesperson should be obtained to confirm that he/she has been consulted.
2. **This form must not be used for urgent decisions.**

January 2015

**BURY COUNCIL
PROPOSED TEMPORARY TRAFFIC CONTROL BY NOTICE
ROAD TRAFFIC REGULATION ACT 1984 SECTION 14(1)**

Name and Lengths of Road(s) Affected	Denton Street, Bury – between Back Hornby Street East and Back Walmerley Road West		
Reason for Notice/Order	To facilitate manhole cover and frame replacement works.		
Nature of Notice/Order	Temporary Closure		
Period of Notice/Order	1 month		
Date of Commencement of Notice/Order	Sunday 12 May 2019		
Anticipated Duration of Works	1 day (08.30-15.30hrs)		
Is the Emergency Procedure being invoked?	YES/NO	Note: For an unforeseen crisis a road may be closed for up to 21 days	
Is a Temporary Order to be made?	YES/NO		
Description of Alternative Route(s)	Via Walmersley Road, Eldon Street and Hornby Street and vice-versa		
Have Notices been Posted?	YES/NO		
Name of Person to be Contacted for Further Information.	Joe Goldstone Tel: 0161-253-5830		
Emergency Closures - Have the following been informed?	Police	YES/NO	
	Fire	YES/NO	NOT
	Ambulance	YES/NO	APPLICABLE
	TfGM	YES/NO	
	Streetworks	YES/NO	
Recharge Code	465 HAM4000 5641		

Head of Engineering _____

Date _____

19/02/19

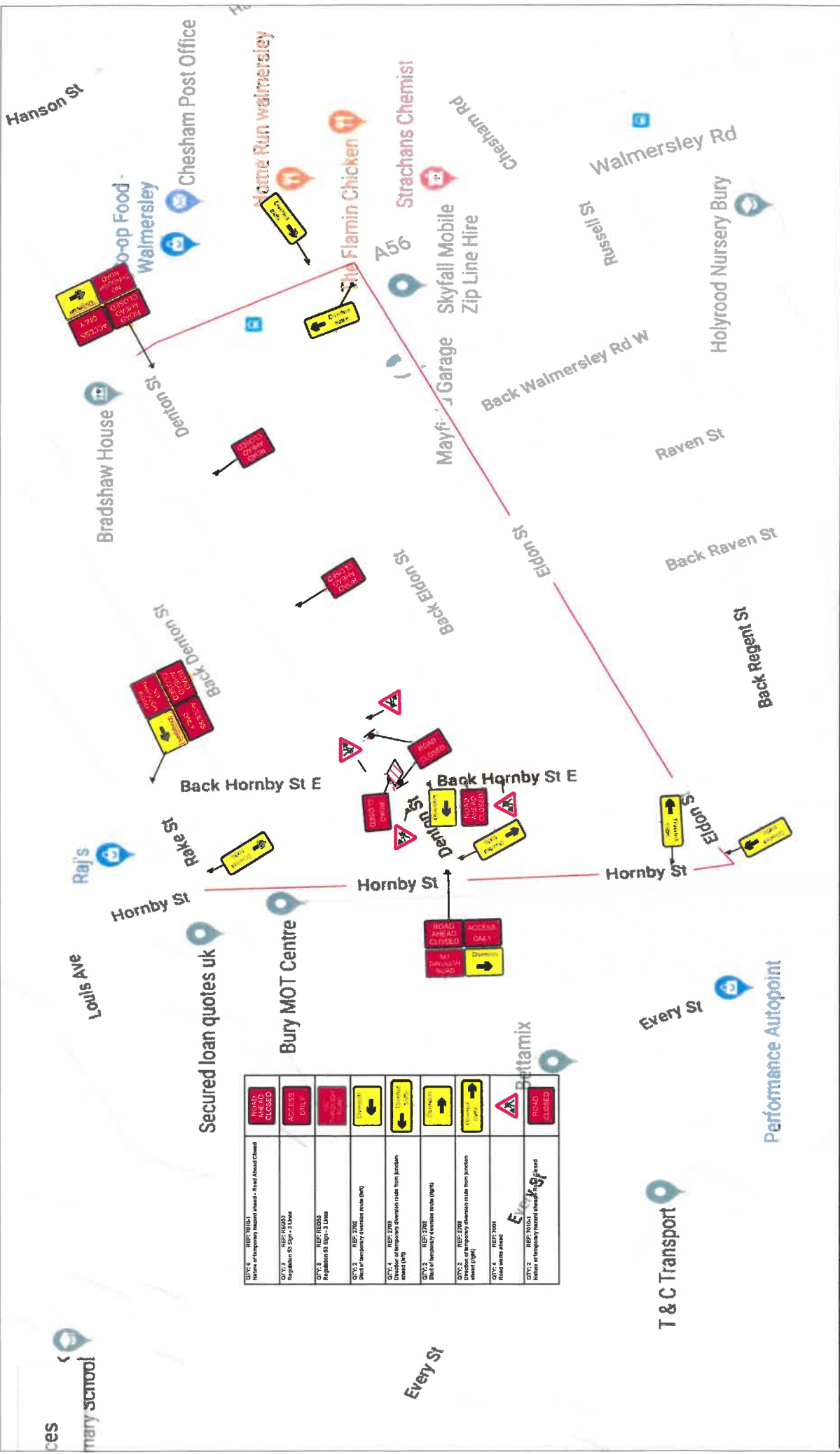

DTV.6	REP: 70161	ROAD AHEAD CLOSED	
Notice of temporary hazard ahead - Road Ahead Closed			
DTV.3	REP: 16163	ACCESS ONLY	
Regulation 63 Sign - 2 Lines			
DTV.5	REP: 16162	ROAD CLOSED	
Regulation 62 Sign - 1 Lane			
DTV.2	REP: 7002	ONE WAY	
Sign of temporary diversion (one way)			
DTV.4	REP: 7003	ROAD CLOSED	
Sign of temporary diversion (one way) from junction			
DTV.1	REP: 7002	ROAD AHEAD CLOSED	
Sign of temporary diversion (one way) ahead (one way)			
DTV.2	REP: 7002	ONE WAY	
Sign of temporary diversion (one way) from junction			
DTV.1	REP: 7001	ROAD AHEAD CLOSED	
Road works ahead			
DTV.2	REP: 7003	ROAD CLOSED	
Notice of temporary hazard ahead (road closed)			

Address:
DENTON ST
BURY
BL9 5AZ

Traffic Management:
ROAD CLOSURE
Drawing No:
2457-0119

Agent:
M ROBINSON

LOCATION OF SIGN ←

LOCATION OF SIGNAL HEAD →

TRAFFIC CONE

DIVERSION ROUTE

WORKING AREA

Checked By: A HOPWOOD

Drawn By: A HOPWOOD

Date: 15/01/19

IF YOU HAVE ANY QUERIES PLEASE CONTACT:
lloyd.simpson@amey.co.uk - 07789170274
paul.simpson@amey.co.uk - 07976343797

Amey Traffic Management
8 FACTORY LANE
HARRPURY
MANCHESTER
M9 9AB
Drawing size A3 - xxxxxx

Traffic Management:
ROAD CLOSURE
Drawing No:
2457-0119

Agent:
M ROBINSON

Signal Times:
All Timings/TM To Be Assessed on Site
And maybe altered
To Suit Traffic and Location, conditions

DETAILS

1. This drawing is the property of Amey Traffic Management Ltd. It is to be used only for the project and location specified. It is not to be used for any other project or location without the written consent of Amey Traffic Management Ltd.

2. The user of this drawing is advised to check the current status of the project and location before using it. Amey Traffic Management Ltd. is not responsible for any errors or omissions in this drawing.

3. The user of this drawing is advised to check the current status of the project and location before using it. Amey Traffic Management Ltd. is not responsible for any errors or omissions in this drawing.